

JMC

White Signature Paradise

Creating Spaces & happiness...

WORK | PLAY | LIVE *In class environment*



- White Signature Paradise

Our passion to be the best and do the best for our clients has always been our leading priority. With enormous experience in the field of construction we have been in business since 1990 and still going strong. WHITE SIGNATURE PARADISE has a house full of talented and exceptional professionals, who are capable of thinking out-of-the-box to deliver unique designs for all genre of businesses, be it residential projects, healthcare, hospitality or commercial ventures.

We stand strong in competence with the current reality scenario and are dedicated to offer professional, affordable, and high quality solutions. Our team, holds 25 years of experience and have been working and building business.

Over the last 10 years, we have successful retained 100% of our clientele. These are statistics that we are proud of and passionately work hard to maintain.

Ariel View



White Signature Paradise

Amenities

Swimming Pool

Childrens Play Area

Gym/Health Club

Club House

Multipurpose Hall

Joging Track

Solar Power Plant
At Terrace

White Signature Paradise is a Hi-Tech Ultra-Premium luxury project in Domasandra (Whitefield). This is in close proximity to IT parks, Railway Station, Schools, Shopping malls, Hospitals and many other Important Destinations. The project is spread on 2.5 Acres of land and will offer 182 units.

*For the First time, we offer **LIVE feed (Web3 Technology)** direct from the construction location. Sitting at your place, you can monitor the construction progress and also video confrence / speak with the site engineer, Lawyer, Sales Manager & Bank Executive on any query.*

It is just 1 hour drive to Kempegowda International Airport. It is one of the Hottest area that guarantees fast appreciating return on investment.



WHITE SIGNATURE PARADISE





Specifications

Structure	<i>R.C.C. framed structure with solid concrete block walls</i>
Plastering	<i>Internal Walls: Cement mortar plastering with lime finish External Walls: Cement mortar plastering with Sponge finish</i>
Doors	<i>Main Door: Teak wood frames with both sides teak flush shutters. Other Doors: Good Quality sal wood/equivalent frames with flush shutters.</i>
Windows	<i>Three Track glazed aluminium sliding windows with safety grills.</i>
Flooring	<i>Vitrified tiles of good quality in living and dining. Antiskid ceramic tiles in toilets.</i>
Painting	<i>Acrylic emulsion for internal walls and ceiling. Snowcem paint for exterior surfaces.</i>
Toilets	<i>Sanitary ware of Hindware, Parryware or equivalent make. Ceramic tile dadoing upto 7ft height. Provision for geyser and exhaust fan.</i>
Kitchen	<i>20mm granite counter platform, with single bowl stainless steel sink. Glazed tile dado upto 2ft above the counter.</i>
Sanitary	<i>All C.P. Fixtures are of Jaguar/Marc or equivalent make.</i>
Electrical	<i>Anchor, Havells or equivalent modular switches. Telephone and TV point in living and all bedrooms.</i>
Generator	<i>Sufficient power backup for lighting in common areas, lifts, pump and each flat.</i>
Lift	<i>1 no. automatic lifts, of 6 passengers capacity, of reputed make for All 3 Blocks.</i>

Typical Floor (Ground, 1st to 6th Floor)

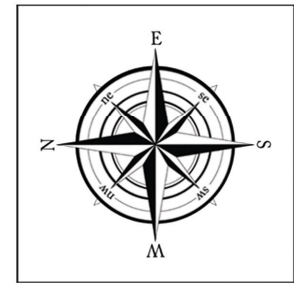

TOWER A



Typical Floor (Ground, 1st to 6th Floor)

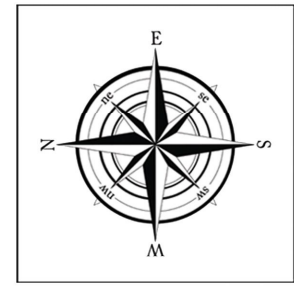

TOWER B



Typical Floor (Ground, 1st to 6th Floor)

TOWER C

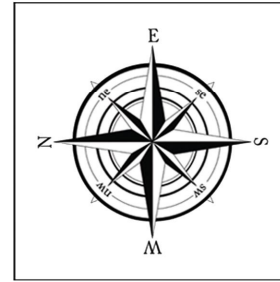

AREA STATEMENT (AREA IN SQ. FT)

NO	UNIT TYPE	S.B.U.A. SQ.FT.
1	A-2-101	1,370.00
2	A-3-102	1,650.00
3	A-2-103	1,270.00
4	A-3-104	1,590.00
5	A-2-105	1,330.00
6	A-3-106	1,600.00
7	A-2-107	1,330.00
8	A-3-108	1,590.00
9	A-2-109	1,270.00
10	A-3-110	1,625.00
11	A-2-111	1,330.00
12	A-3-112	1,610.00
13	B-3-101	1,610.00
14	B-2-102	1,330.00
15	B-3-103	1,590.00
16	B-2-104	1,380.00
17	B-3-105	1,590.00
18	B-2-106	1,330.00
19	B-3-107	1,600.00
20	B-2-108	1,370.00
21	B-3-109	1,600.00
22	B-2-110	1,330.00
23	C-3-101	1,650.00
24	C-3-102	1,650.00
25	C-3-103	1,650.00
26	C-3-104	1,670.00

Stilt Floor - Parking Layout

1. Security booth
2. Tower A ground floor
3. Tower B ground floor
4. Tower C ground floor
5. Club house
6. Swimming pool
7. Badminton court
8. Childrens play area
9. STP / WTP
10. Land scap area
11. Transformer yord

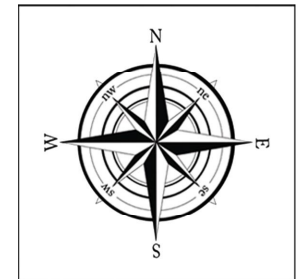

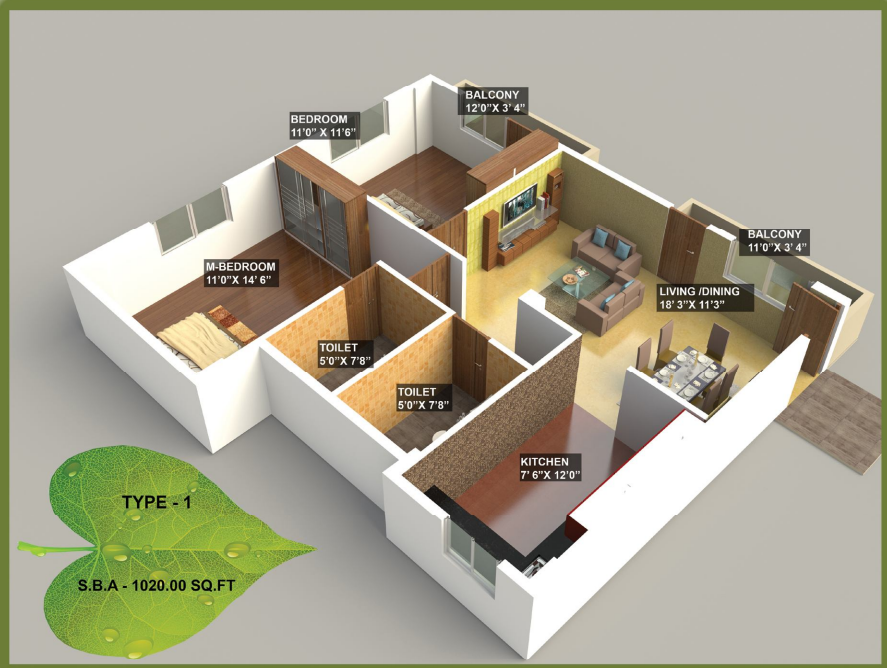

Amenities



Swimming Pool

A well maintained closed pool with high standards of hygiene and safety for your loved ones.

Childrens Play Area

Play gives children a chance to practice what they are learning. Let your children play without you worrying about their safety.

Gym/Health club

To keep yourself in shape, here comes a well equipped gym within the apartment complex.



Club House

Step in for a game or play table tennis at the well equipped club house.

Multipurpose Hall

Makes private entertaining a pleasure, without the hassle of looking out for occasions like family get togethers, parties or other celebrations.

Jogging Track

We have thought of many ways to keep you and your family in good health. Just look out of your window and see your spouse enjoying a good jog on the all round jogging track.

Round the clock security

Your security is our prime concern, which is why besides an all round compound wall we have professional 24 hours security personnel.

24 hrs water supply

24 hours water supply from borewell and overhead tank.



Completed Projects



Ongoing Projects



Location Map



Proximity

Old Madras Road
- 03.00 Km

Sai baba Ashram &
Whitefield Railway
Station
- 01.00 Km

Phoenix Market City
- 04.00 Km

ITPL
- 03.00 Km

K.R Puram
Railway Station
-05.00 Km

Marathahalli
- 06.00 Km



ARCHITECTS:
JMC Structures
No. 454, Sri Lakshmi complex,
T.C. Palya, Old Madras Road,
Bangalore - 560049.
Mobile: 9900237603
Email: jmcstructures@yahoo.com
web: www.jmcstructures.com



STRUCTURAL ENGINEERS:
Umesh & Company
No. 194, Madhava Villa,
Flat No. 02, 17th Cross,
M.C. Layout, Vijaynagar,
Bangalore - 560040.
Mobile: 9844027446
Email: umesh.co@gmail.com



PROJECT DEVELOPED:
JMC Infracon Pvt. Ltd.,
No. 454, Sri Lakshmi complex,
T.C. Palya, Old Madras Road,
Bangalore - 560049.
Mobile: 7760111666
Email: info@jmcinfracon.com
web: www.jmcinfracon.com